

Lakewood

SPECIFICATIONS

Why not add your own touch of luxury and additional functionality with the following options:

Platinum pack

- Bluetooth surround sound system
- Trace heating
- Connection for washing machine
- Artefoam Cladding
- BS3632:(2015) residential specification

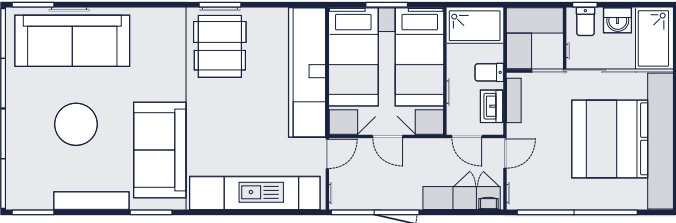

- SIZES**
1. 42 ft x 13 ft 2 Bedrooms
 2. 42 ft x 14 ft 2 Bedrooms (Residential Standard BS3632)

Lifestyle pack

(Included as standard)

- Gas condensing combi boiler
- Thermostatic radiators
- Low-E glass on all double glazing

INTERIOR	
'Bead-less' internal wallboards and MDF tongue and groove fluted ceiling	✓
Bluetooth surround sound system	P / O
Brushed metal switches and sockets	✓
Velux roof windows in living area	O
Fluted privacy glass (in entrance doors, bathrooms windows, glazed internal doors* and apex window)	✓
Gas condensing combi boiler with thermostatic radiators	✓
Entrance hall	✓
Trace heating	P / O
KITCHEN/DINING AREA	
Integrated appliances (fridge/freezer, microwave and dishwasher)	✓
5 ring gas hob, electric oven and grill with integrated cooker hood	✓
Reginox 1.5 bowl sink with hardwood over sink chopping board	✓
Hafele domestic soft close drawers and pull out larder unit	✓
Connection for washing machine	P / O
Freestanding dining table with padded dining chairs	✓
LOUNGE	
Freestanding 3 seater and 2 seater sofas	✓
3 seater sofa includes pull out bed	✓
Integrated electric fire with built in cabinet surround and coordinating coffee table	✓

TV points and electrical sockets with integrated USB ports	✓
MASTER BEDROOM	
King size divan style bed (with storage), feature headboard and SoCoozee mattress	✓
Hypnos mattress	O
Bedside cabinets and matching dressing table/vanity unit with mirror	✓
NatureWall feature	✓
French or sliding doors	O
Integrated bedside/reading lighting	✓
Walk-in wardrobe with hanging space, drawers and shelving	✓
Mirrored sliding doors to provide access to en suite and walk-in wardrobe	✓
USB charging points, TV aerial point and 240v sockets	✓
Full en suite with shower, w/c and sink with vanity unit, in the same great spec as bathroom	✓
BS3632:(2015) residential specification	P / O
SECOND BEDROOM	
Twin divan style beds (with storage), feature headboards and SoCoozee mattresses	✓
Bedside cabinet, coordinating storage cupboards and mirror	✓
USB charging points, TV aerial point and 240v sockets	✓
BATHROOM	
Domestic shower tray with wetwall and dual thermostatic shower with fixed rainfall head	✓
Close coupled ceramic toilet with dual flush	✓
Basin with drawered vanity unit and mirrored vanity cabinet	✓
Velux roof window	✓
EXTERIOR	
Timberwolf CanExel Ultraplank side feature	✓
Chateau grey aluminium cladding	✓
Artefoam Cladding	P / O

CanExel, timber and environmental coloured aluminium cladding options	O
Anthracite coloured uPVC glazing	✓
Large glazed front with French doors	✓
Exterior light	✓
Roof overhang to front aspect with LED lights	✓
Fully galvanised Protech chassis	✓
Twin axle chassis	✓
KEY: ✓ = Standard O = Optional Extra P = Platinum Pack x = Not Available	

Key features:

- Contemporary open plan living space
- Luxurious master bedroom with walk-in wardrobe and en-suite shower
- Spacious twin bedroom with single beds
- TimberWolf CanExel Ultraplank side feature focal roof overhang with LED aspect lighting
- VELUX roof windows