

# Stonewood

## SPECIFICATIONS

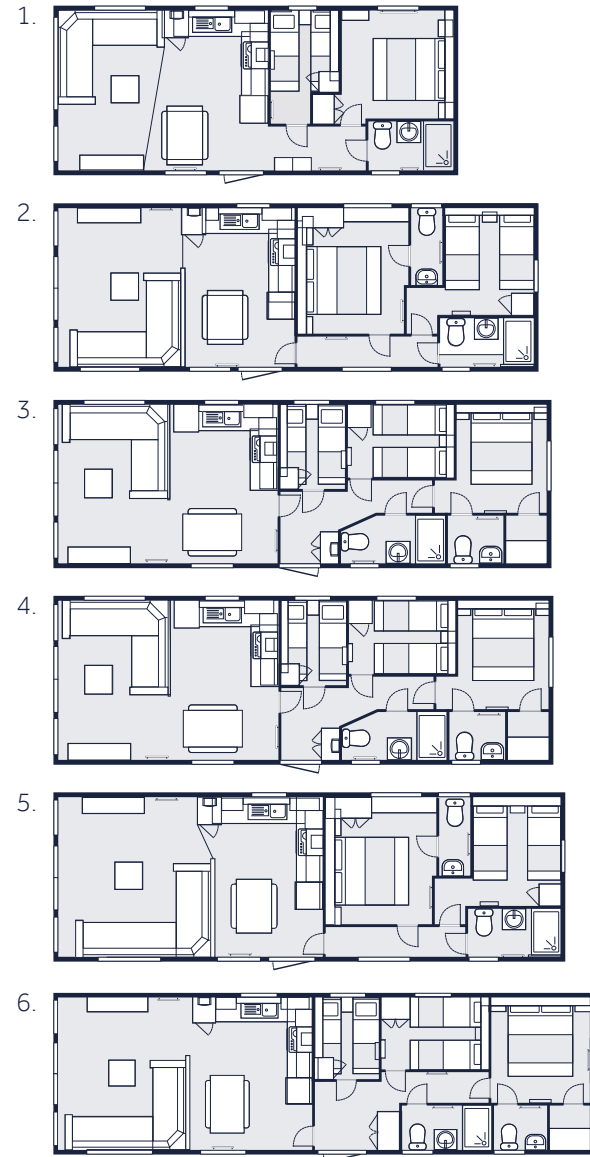

Why not add your own touch of luxury and additional functionality with the following options:

### Lifestyle pack

- Gas condensing combi boiler
- Thermostatic radiators
- Low-E glass on all double glazing

### Key features:

- Available in a range of model sizes
- Two or three bedroom options available
- Large shower, basin and built-in vanity cabinet
- Neutral wood tones throughout

### SIZES

- |                             |                             |
|-----------------------------|-----------------------------|
| 1. 29 ft x 12 ft 2 Bedrooms | 4. 37 ft x 12 ft 2 Bedroom  |
| 2. 35 ft x 12 ft 2 Bedrooms | 5. 39 ft x 12 ft 2 Bedrooms |
| 3. 36 ft x 12 ft 3 Bedrooms | 6. 41 ft x 12 ft 3 Bedrooms |

# Stonewood

## SPECIFICATIONS (CONT.)

	29x12 2 Bed	35x12 2 Bed	36x12 3 Bed	37x12 2 Bed	39x12 2 Bed	41x12 3 Bed
Lifestyle pack	○	○	○	○	○	○
<b>INTERIOR</b>						
'Bead-less' internal wallboards	✓	✓	✓	✓	✓	✓
Bluetooth sound system	○	○	○	○	○	○
Velux roof windows in living area	○	○	○	○	○	○
Water heater	✓	✓	✓	✓	✓	✓
Trace heating	○	○	○	○	○	○
Bespoke print curtains and scatter cushions	✓	✓	✓	✓	✓	✓
<b>KITCHEN/DINING AREA</b>						
Integrated fridge/freezer	✓	✓	✓	✓	✓	✓
Shelving for microwave to help keep work surfaces clear	✓	✓	✓	✓	✓	✓
Integrated microwave	○	○	○	○	○	○
Integrated dishwasher	○	○	○	○	○	○
Integrated washing machine	○	○	X	○	○	○
4 ring gas hob, electric oven and grill with built in cooker hood	✓	✓	✓	✓	✓	✓
Stainless steel sink with coordinating tap	✓	✓	✓	✓	✓	✓
Coordinating dining table and bench seating	✓	✓	✓	✓	✓	✓
<b>LOUNGE</b>						
Built in sofa bed	✓	✓	✓	✓	✓	✓
L-shaped sofa	✓	✓	✓	✓	✓	✓
Integrated fireplace	✓	✓	✓	✓	✓	✓
Coordinating coffee table	✓	✓	✓	✓	✓	✓
<b>MASTER BEDROOM</b>						
Double bed with feature headboard and mattress	✓	✓	✓	✓	✓	✓

Hypnos mattress	○	○	○	○	○	○
Bedside cabinets, wardrobe and matching dressing table/vanity unit with mirror	✓	✓	✓	✓	✓	✓
Integrated bedside/reading lighting	✓	✓	✓	✓	✓	✓
USB charging points and 240v sockets	✓	✓	✓	✓	✓	✓
TV aerial point	○	○	○	○	○	○
En suite extractor fan	X	○	○	○	○	○
En suite with close coupled ceramic toilet and pedestal sink	X	○	○	○	○	○
<b>ADDITIONAL BEDROOMS</b>						
Twin beds with metal bedframes, feature headboards and mattresses	✓	✓	✓	✓	✓	✓
Bedside cabinet, coordinating featuring shelving, storage cupboards and mirror	✓	✓	✓	✓	✓	✓
USB charging points and 240v sockets	✓	✓	✓	✓	✓	✓
TV aerial point	○	○	○	○	○	○
<b>BATHROOM</b>						
Large shower enclosure with thermostatic shower	✓	✓	✓	✓	✓	✓
Close coupled ceramic toilet with dual flush	✓	✓	✓	✓	✓	✓
Basin with vanity unit and mirrored vanity cabinet	✓	✓	✓	✓	✓	✓
<b>EXTERIOR</b>						
Low gloss champagne aluminium cladding	✓	✓	✓	✓	✓	✓
CanExel, timber, Artefoam Plastic and coloured aluminium cladding options	✓	✓	✓	✓	✓	✓
White uPVC Glazing	✓	✓	✓	✓	✓	✓
Coloured uPVC Glazing	○	○	○	○	○	○
Front French doors	○	○	○	○	○	○
Front patio doors	○	○	○	○	○	○
Exterior light	✓	✓	✓	✓	✓	✓
Painted chassis	✓	✓	✓	✓	✓	✓
Fully galvanised Protech chassis	○	○	○	○	○	○
Single axle chassis	✓	✓	✓	X	X	X
Twin axle chassis	X	X	X	✓	✓	✓

**KEY:** ✓ = Standard ○ = Optional Extra L = Optional Extra x = Not Available